

# FINEPOWER

LiFePO<sub>4</sub> Dash Cam Auxiliary Battery

## FinePower 250

**This product requires professional installation.**

If self-installation is difficult, have it installed by a professional.

Any damage to the product or vehicle resulting from self-installation is the responsibility of the user.

## Safety and Precautions

- Do not arbitrarily disassemble or alter the product.
- This product is designed for use with 12V vehicles only.
- Be sure to install it using the enclosed FineVu genuine fuse tap.
- When connecting it to the fuse box, make sure to correctly identify the IN and OUT terminals.
- When connecting it to the fuse box, avoid critical systems such as the engine or steering fuses.
- Connect it only to accessory fuses that are not directly related to vehicle operation, such as interior lights, audio system, cigarette lighter plug, sunroof, trunk, or power seats.
- Do not expose the product to direct sunlight or water.

## Product Composition

### Components



FinePower 250



Input Cable  
(2 m / 78.7 in)



Output Cable  
(2 m / 78.7 in)



Multi-Fusebox  
Cable



Mounting Tape  
(2EA)



User Manual

### Optional Accessories



Cigarette Lighter  
Plug Cable  
(30 cm / 11.8 in)



Tesla Y Cable



Input Cable  
(5 m / 196.9 in)

## Product Specifications

Item	Specifications	Remarks
Model Name	FinePower 250	
Size	135.0 x 175.0 x 32.0mm (5,3 x 6.9 x 1.3 in)	
Weight	965g (34.0 oz)	
Rated Output	8.6V~12.5V/1A (MAX 1.5A)	Lithium Iron Phosphate 9.6V/8A
Battery Charging Time	About 70 minutes	
Operation Temperature	0 ~ 60°C (32 ~ 140°F)	When a high temperature of 80°C (176°F) or above is detected, the power is automatically shut off to protect the battery pack.
Certification	R-R-FDK-FinedriveA039 Safety Certification: XU103017-22001A 	Passed the KS C 9990 (Test for Electromagnetic Compatibility of Automobiles and Internal combustion Engines)

\* Battery operating time may vary depending on the usage environment.

## Supported Models

Support for the battery level display function may vary by model. For more details, contact FineVu Customer Support Center. (support@finedigital.com)

## Name of Parts

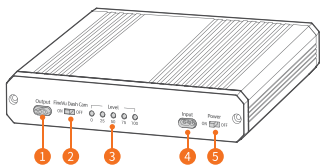

Name	Function
1 Output	Connects the auxiliary battery and the dash cam.
2 FineVu Dash Cam	<ul style="list-style-type: none"> <li>*When connecting a FineVu dash cam, set it to ON to view battery status and other information in the FineVu app.</li> <li>*When connecting other brand dash cams, set this to OFF.</li> <li>*Otherwise, some features may not operate properly.</li> <li>*If any external accessories are connected to the ACC line of the output cable, set this to OFF. Otherwise, some features may not operate properly.</li> <li>*Battery information is updated every 5 minutes.</li> </ul>
3 Level	<p>The battery level is indicated via LED lights in five stages: 0% / 25% / 50% / 75% / 100%.</p> <ul style="list-style-type: none"> <li>*If the remaining battery level falls below 20%, the dash cam will switch to Power Saving Parking mode.</li> <li>(Only for models that support Power Saving Parking mode)</li> <li>*Battery level accuracy improves over time through charge/discharge learning, so the displayed level may be slightly inaccurate during initial use.</li> </ul>
4 Input	<p>Connects the auxiliary battery and the vehicle.</p> <ul style="list-style-type: none"> <li>*Use the Multi-fusebox cable to connect to the appropriate fuse in your vehicle.</li> <li>*The cigarette lighter plug cable and Tesla Y cable are optional accessories and sold separately.</li> </ul>
5 Power	<p>Turns on and off the power of the auxiliary battery.</p> <ul style="list-style-type: none"> <li>*If the auxiliary battery is not in use, set both 'FineVu Dash Cam' and 'Power' to OFF. Otherwise, the dash cam may not operate properly.</li> <li>*If the auxiliary battery is OFF, parking mode on the dash cam will be unavailable.</li> </ul>



- Forcing the cable connection may cause damage. Make sure each terminal is appropriately set before connecting the cable.

## How to Install

### Install to Fuse Box

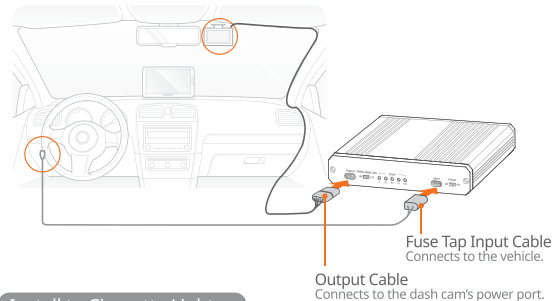

### Install to Cigarette Lighter

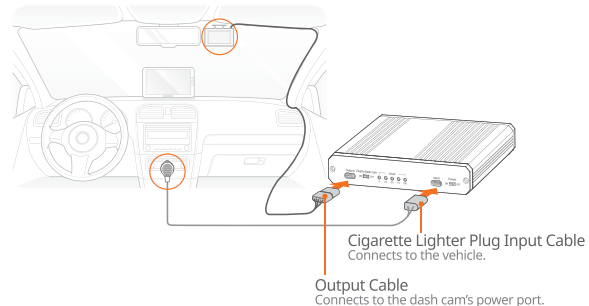

- The installation method may differ depending on the vehicle type and mounting location.

## How To Use Multi-Fusebox Cable (VCC Connection)

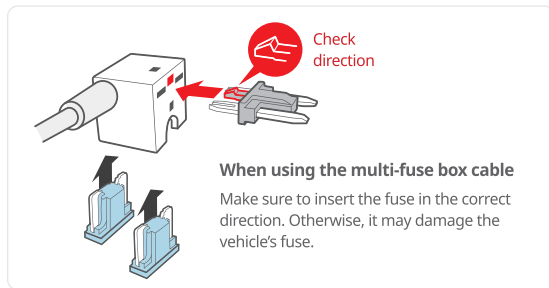
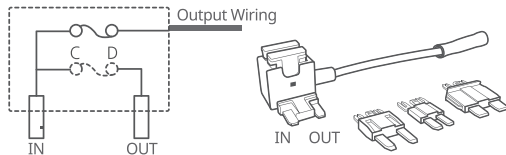

### When using the multi-fuse box :

- Remove the fuse, use a tester to find the power input side (IN), and make sure to connect the IN terminal to it. Incorrect installation may damage the vehicle's original fuse.

### If a tester is not available :

- When the fuse in the multi-fuse box is oriented upward, connect the left side to IN and the right side to OUT.  
(Refer to images above and be careful not to damage the vehicle's fuse box when installing.)

## Limited Warranty

FineVu warrants this product to the original purchaser against defects in materials and workmanship under normal use for a period of one (1) year from the date of purchase.

### Warranty Coverage

- This warranty applies only to products and accessories purchased from authorized FineVu dealers or resellers.
- It is valid only for the original purchaser and is non-transferable.
- Proof of purchase (such as a receipt or order confirmation) is required to obtain warranty service.
- If a defect is found within the warranty period, FineVu may, at its sole discretion, provide one of the following solutions:
  - Replacement with a new unit;
  - Replacement with a functionally equivalent model;
  - If the original model is discontinued or out of stock, replacement with a refurbished, reconditioned, or pre-owned unit of similar functionality.

### Warranty Exclusions

This warranty does not cover the following:

- Products purchased from unauthorized sellers or unofficial distribution channels.
- Damage or malfunction resulting from:
  - Misuse, abuse, dropping, impact, or improper storage;
  - Unauthorized disassembly, modification, or repair;
  - Normal wear and tear, or cosmetic damage such as scratches;
  - Use with uncertified third-party accessories or equipment.
- Failures caused by external factors such as natural disasters, power issues, or abnormal environmental conditions.
- Any costs related to installation, removal, transportation, or reinstallation of the product or its accessories.

### Limitation of Liability

FineVu shall not be held liable for any direct, indirect, incidental, or consequential damages, including but not limited to loss of data, property damage, personal injury or death, or loss of revenue or business opportunities, arising from the use or failure of the product.

- This limited warranty grants you specific legal rights, and you may have additional rights depending on your jurisdiction.

### Warranty Service Process

- Customers are responsible for shipping the product to the original place of purchase or an authorized service center at their own expense.
- Replacement products or parts provided under this warranty are covered for 90 days or the remainder of the original warranty period, whichever is longer.

**FINE Vu**

<http://en.finevu.com>

**FineVu Customer Center** : [support@finedigital.com](mailto:support@finedigital.com)

This manual describes the features of the product necessary to use it.